

# PLUG FOR PLUGGABLE TERM. BLOCK SCREW



## BCEC350\*, BCCPC350\* SERIES. 3.50 mm (0.138") pitch. For wire screw type.

### General Features

- Available in 2 through 24 circuits
- Mates with 3.50 mm pitch headers (sockets) pluggable terminal blocks
- Front or side wire entry. Full polarised
- Meet IEC 61984 and UL 1059 requirements and are approved by UL and VDE

### Materials

- Insulator: PA66 UL 94 V-0
- Contact: Electrolytic cooper tin plated
- Screw: High-strength steel alloys M2 zinc plated
- Wire cage: cooper nickel plated
- Operating temperature: -40°C to +105°C
- RoHS compliant

### Electrical Features

- Voltage rating: 300V UL / 320 V IEC
- Rated current: 8 A UL / 14 A IEC (6A for BCCP350 Series)
- Contact resistance: < 20 mΩ
- Rated surge voltage: 1600V UL / 2500 V IEC
- Insulation resistance: >500 MΩ

### Mechanical features

- Wire strip length: 6.00 to 7.00 mm.  
(4.00 to 5.00 mm. for BCCP350 Series)
- Conductor cross-section: AWG 28-14
- Torque (N-m): 0.19
- Durability: 25 cycles

### Dimension Information

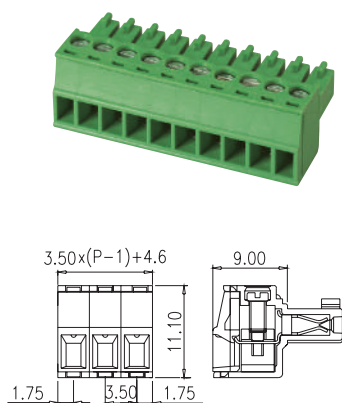

P/N: **BCEC350V-XX-P**

XX= N° CONTACTS

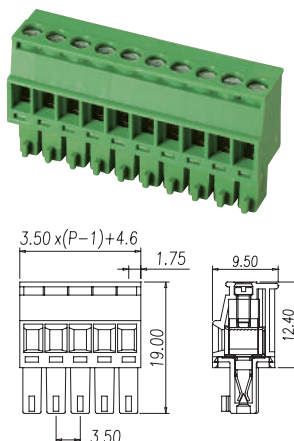

P/N: **BCEC350R-XX-P**

XX= N° CONTACTS

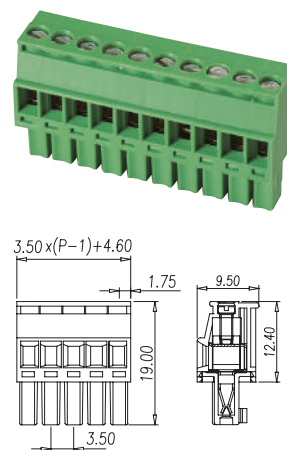

P/N: **BCEC350RL-XX-P**

XX= N° CONTACTS

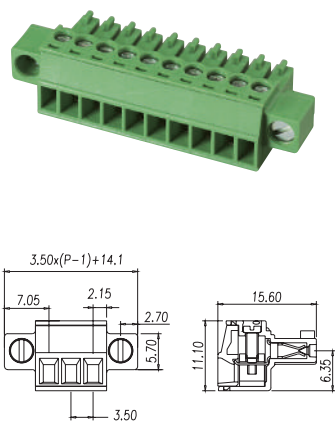

P/N: **BCEC350VM-XX-P**

XX= N° CONTACTS

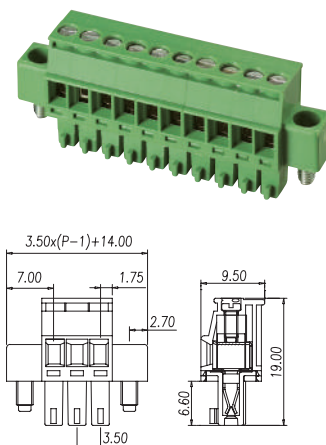

P/N: **BCEC350RM-XX-P**

XX= N° CONTACTS

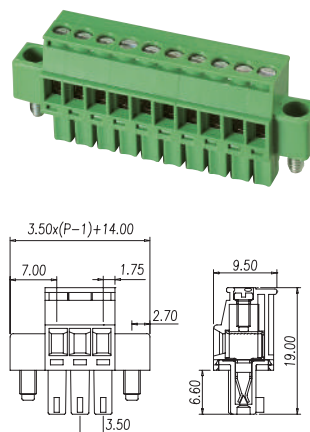

P/N: **BCEC350RLM-XX-P**

XX= N° CONTACTS

# PLUG FOR PLUGGABLE TERM. BLOCK SCREW



**BCEC350\*, BCCPC350\* SERIES.** 3.50 mm (0.138") pitch. For wire screw type.

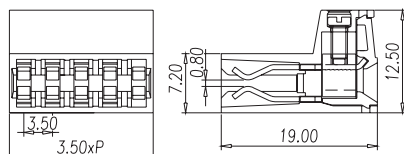
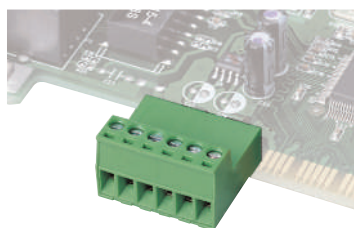

P/N: **BCCPC350-XX-P**  
XX= N° CONTACTS

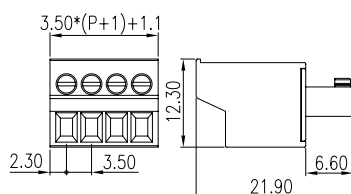

P/N: **BCEC350F-XX-P**  
XX= N° CONTACTS

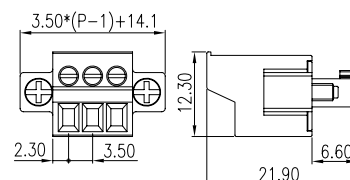

P/N: **BCEC350FM-XX-P**  
XX= N° CONTACTS

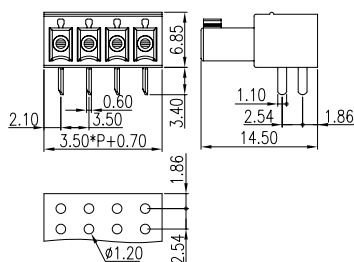

P/N: **BCEC350CR-XX-P**  
XX= N° CONTACTS

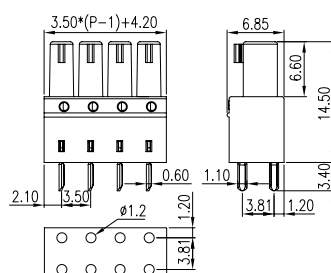

P/N: **BCEC350CV-XX-P**  
XX= N° CONTACTS

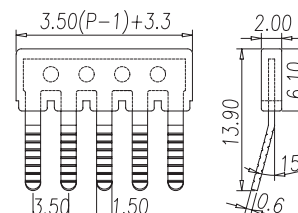
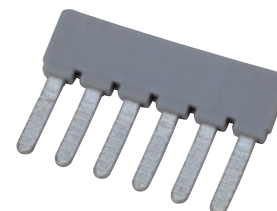

P/N: **BCCSC-01-XX-P**  
XX= N° CONTACTS