

# D-SUB RIGHT ANGLE PCB SOCKET CONNEC.



## 8007 SERIES. 8.10 mm. Foot Print D Sub. With ferrite.

### General Features

- Available in 9, 15, 25 and 37 ways
- Contact area: selective gold plating over nickel
- Solder area: tin plating over nickel
- Different hardware options
- Contact sales office

### Materials

- Insulator: Glass-Filed Thermoplastic PBT, UL94V-0 rated
- Contact: Phosphor bronze
- Shell : Steel, 100 μ Tin over 50 μ Min. Copper
- Clinch Nut : Brass, Nickel Plated
- Screwlock : Brass, Nickel Plated
- Operating temperature. -25°C to +85°C
- RoHS compliant

### Dimension Information

### Electrical Features

- Voltage rating: < 250 V
- Current rating: < 3 A
- Contact resistance: < 20 mΩ
- Dielectric withstanding Voltage: 500 V AC/minute
- Insulation resistance: >1000 MΩ

### Mechanical Features

- Insertion force per contact: < 0.34 Kgf
- Withdrawal force per contact: < 0.030 Kgf
- Durability: 500 Cycles



Circuits	Part Number	Dimensions		
		A	B	C
9	<b>8007 – T09C</b>	30.80 (1.213)	25.00 (0.984)	16.33 (0.643)
15	<b>8007 – T15C</b>	39.20 (1.543)	33.30 (1.311)	24.66 (0.971)
25	<b>8007 – T25C</b>	53.10 (2.091)	47.10 (1.854)	38.38 (1.511)
37	<b>8007 – T37C</b>	69.40 (2.732)	63.50 (2.500)	54.84 (2.159)

### T = Contact Plating

- T = 3. Gold flash over 50μ" nickel.
- T = 4. 10μ" gold over 50μ" nickel
- T = 5. 15μ" gold over 50μ" nickel
- T = 6. 30μ" gold over 50μ" nickel

### C = Hardware Options

- C = 1. Riveted ground hooks pre-loaded #4.40 UNC Hex screws (standard)
- C = 0. Riveted ground hooks with #4.40 UNC open

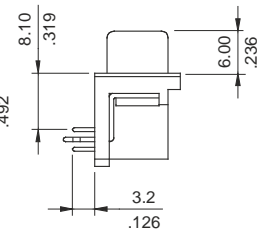
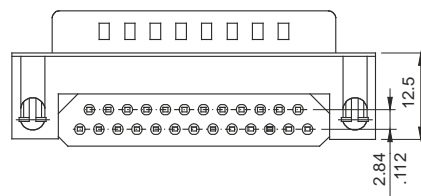
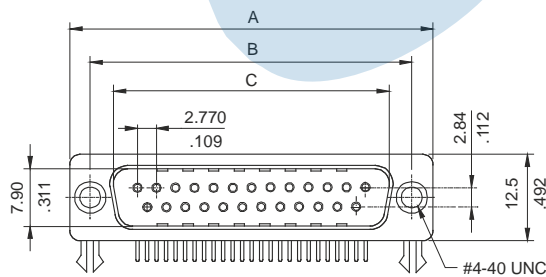

RECOMMENDED HOLE PATTERN

