

D-SUB CRIMP SOCKET CONNECTOR



8003 SERIES. D Sub socket connector.

General Features

- Available in 9, 15, 25, 37 and 50 circuits
- Use D sub male terminals 8502 and 8504 series
- Use hood 8030, 8031, 8034, 8029 and 8027 series
- Different hardware options. Contact sales office

Materials

- Insulator: Glass-Filled Thermoplastic PBT, UL94V-0 rated
- Contact: Phosphor bronze
- Shell : Steel, 100U Tin Over 50U Min Copper
- Clinch Nut : Brass, Nickel Plated
- Screwlock : Brass, Nickel Plated
- Operating temperature. -25°C to +85°C
- RoHS compliant

Dimension Information

Electrical Features

- Dielectric withstanding Voltage: 500 V AC/minute
- Insulation resistance: >1000 MΩ

Mechanical Features

- Insertion force per contact: < 0.34 Kgf
- Withdrawal force per contact: > 0.030 Kgf
- Durability: 500 Cycles

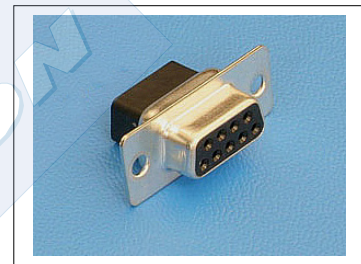

Circuits	Part Number	Dimensions			
		A	B	C	D
9	8003 – 209C	16.33(0.643)	24.99 (0.984)	30.81 (1.213)	19.23 (0.757)
15	8003 – 215C	24.66 (0.971)	33.32 (1.312)	39.14 (1.541)	27.56 (1.085)
25	8003 – 225C	38.38 (1.511)	47.04 (1.852)	53.04 (2.088)	41.28 (1.625)
37	8003 – 237C	54.84 (2.159)	63.50 (2.500)	69.32 (2.729)	57.73 (2.273)
50	8003 – 250C	52.43 (2.064)	61.11 (2.406)	66.93 (2.635)	55.12 (2.170)

C = Hardware Options

- C = 1. Standard with 3.05mm(.012") dia. mount hole
- C = 2. T2 Version
- C = 3. T4 Version
- C = 4. D2 Version

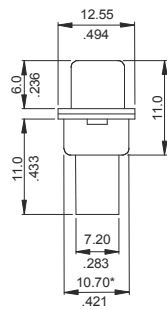
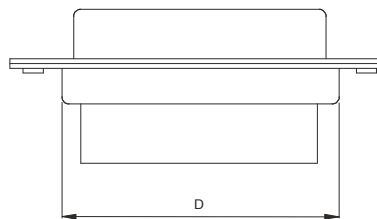
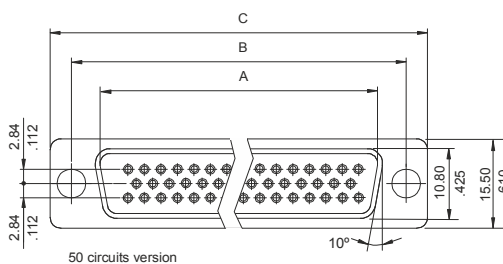
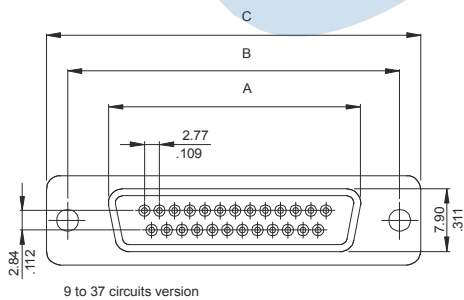

* For 50 circuits this dim. is 13.50 mm.

