

SIDE ENTRY SHIELDED PCB JACK FCC-68



7687 SERIES. Right angle PCB jack. With leds and filters.

General Features

- Available in 8/8 circuits
- Standard telephone jack FCC-68
- 13.85 mm. height
- Accept standard plugs FCC-68 type
- Selective gold plating with different finish
- Bifurcated plastic foot print
- With leds and Lan filter. Different filter options

Materials

- Insulator: Thermoplastic UL 94V-0
- Contact: 0.35 mm thickness phosphor bronze
- Shielded: 0.25 mm thickness brass
- Operating temperature. -25°C to + 85°C
- RoHS compliant

Dimensional Information

Electrical Features

- Voltage rating: < 125V
- Current rating: < 1.50 A
- Contact resistance: < 20 mΩ
- Dielectric withstanding voltage: 300 V AC/minute
- Insulation resistance: >1000 MΩ

Mechanical Features

- Durability: 1000 cycles

Part Number				Colour Led	
Type A	Type B	Type C	Type D	LED 1	LED 2
7687 – T8800F*	7687 – T8800F*	7687 – T8800F*	7687 – T8800F*	W/O Led	W/O Led
7687 – T8811F*	7687 – T8812F*	7687 – T8813F*	7687 – T8814F*	Green	Yellow
7687 – T8821F*	7687 – T8822F*	7687 – T8823F*	7687 – T8824F*	Yellow	Green
7687 – T8831F*	7687 – T8832F*	7687 – T8833F*	7687 – T8834F*	Green	Green
7687 – T8841F*	7687 – T8842F*	7687 – T8843F*	7687 – T8844F*	Yellow	Yellow

*Replace F for the filter (Check options filter in the next pages)

Type A

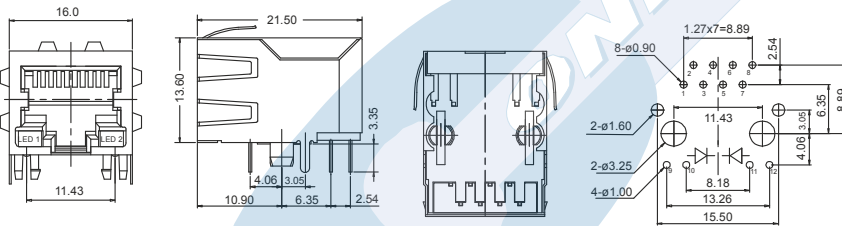

Type B

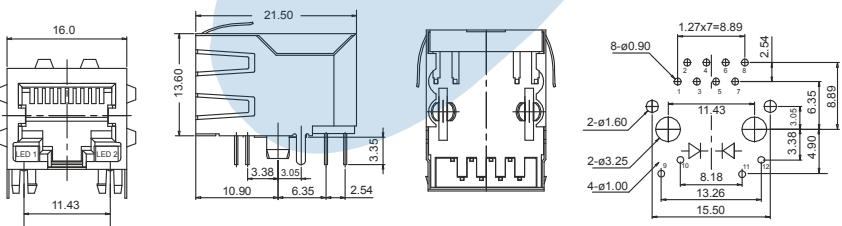

Type C

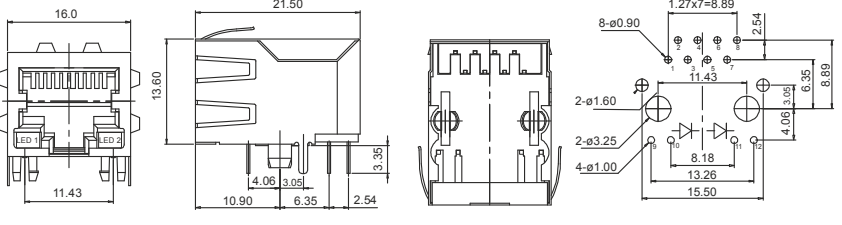

Type D

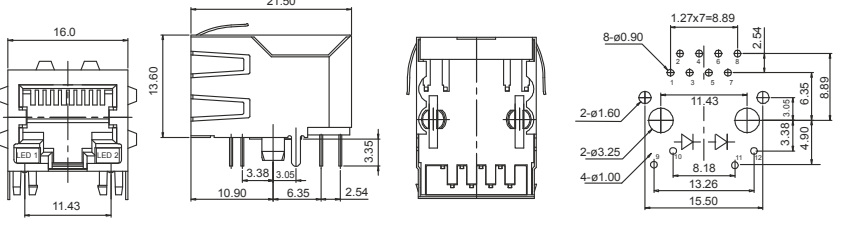

T = Contact Plating

- T = 4. 6µ" gold over 50µ" nickel
- T = 5. 15µ" gold over 50µ" nickel
- T = 6. 30µ" gold over 50µ" nickel
- T = 7. 50µ" gold over 50µ" nickel

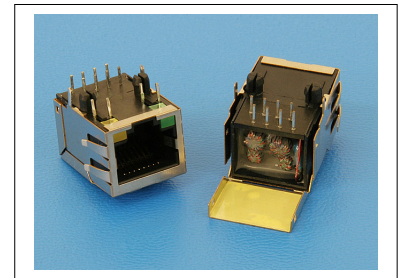

SIDE ENTRY SHIELDED PCB JACK FCC-68



7687 SERIES. Right angle PCB jack. With leds and filters.

Filter Type:

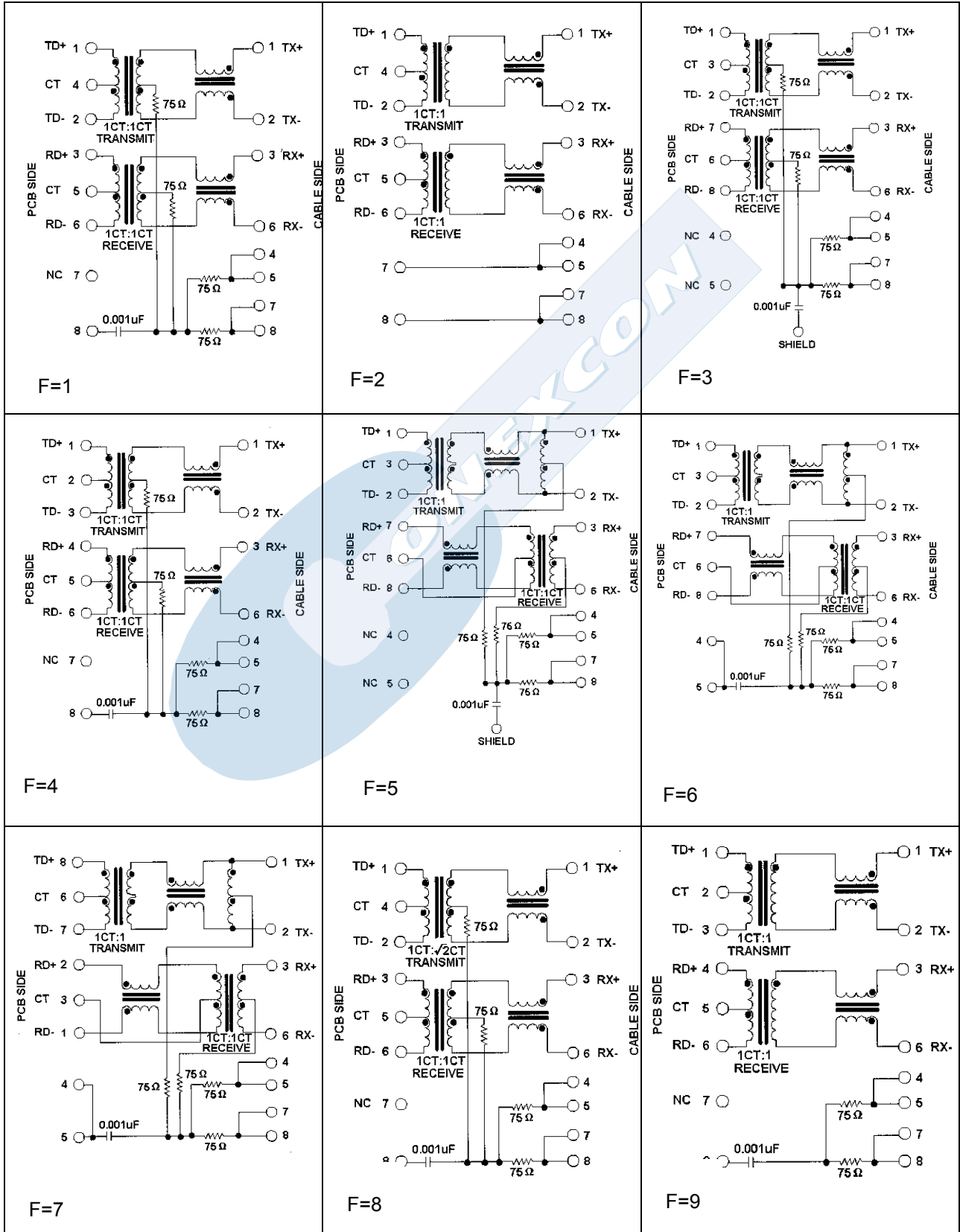

SIDE ENTRY SHIELDED PCB JACK FCC-68



7687 SERIES. Right angle PCB jack. With leds and filters.

Filter Type:

