

SIDE ENTRY SMT JACK FCC-68



7641 SERIES. Right angle PCB jack.

General Features

- Available in 4/4, 6/4, 6/6, 8/8 and 10/10 circuits
- Standard telephone jack FCC-68
- Low profile: 11.50 mm. height
- Accept standard plugs FCC-68 type
- Selective gold plating with different finish
- Bifurcated plastic foot print

Materials

- Insulator: Thermoplastic UL 94V-0
- Contact: 0.35 mm thickness phosphor bronze
- Operating temperature. -25°C to + 85°C
- RoHS compliant

Dimensional Information



Electrical Features

- Voltage rating: < 125V
- Current rating: < 1.50 A
- Contact resistance: < 20 mΩ
- Dielectric withstanding voltage: 300 V AC/minute
- Insulation resistance: >1000 MΩ

Mechanical Features

- Durability: 1000 cycles

Circuit Size	Part Number	Dimensions		
		A	B	C
4/4	7641 – T441	11.21 (0.442)	7.62 (0.300)	3.81 (0.150)
6/4	7641 – T641	12.96 (0.511)	10.16 (0.400)	3.81 (0.150)
6/6	7641 – T661	12.96 (0.511)	10.16 (0.400)	6.35 (0.250)
8/8	7641 – T881	15.24 (0.600)	11.43 (0.450)	8.89 (0.350)
10/10	7641 – T101	15.24 (0.600)	11.43 (0.450)	11.43 (0.450)

T = Contact Plating

- T = 4. 6μ" gold over 50μ" nickel
- T = 5. 15μ" gold over 50μ" nickel
- T = 6. 30μ" gold over 50μ" nickel
- T = 7. 50μ" gold over 50μ" nickel

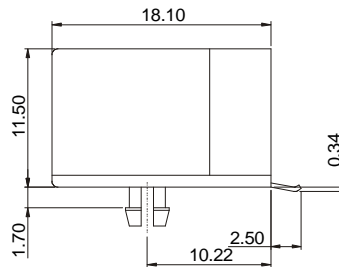
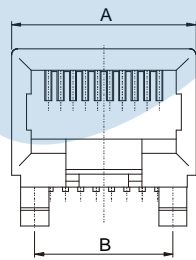

RECOMMENDED PCB LAYOUT

