

SPLICE WATERPROOF IP67



3235 SERIES. Splice IP 67.

General Features

- Available for cable: 18 AWG (Red colour) and 14-16 AWG (Green colour)
- Wire trap retention wire. Quickly assembly
- OD maximum: 2,55 mm for 14 AWG
2,25 mm for 16 AWG
2,00 mm for 18 AWG

Materials

- Base Insulator: Polycarbonate UL 94V-0
- Contact: Cooper alloy
- Cover: Polycarbonate UL 94V-0
- Ruber: EPDM
- Operating temperature: -25°C to + 85°C
- RoHS compliant

Dimensions

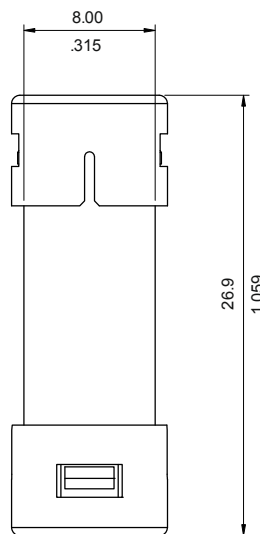
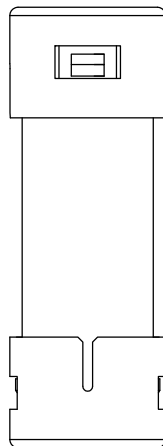
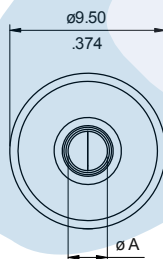
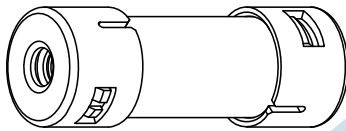

Electrical Features

- Current rating: < 15 A (14 AWG); 10 A(16 AWG) and 7,50 A(18 AWG)
- Contact resistance: < 10 m Ω
- Dielectric Withstanding Voltage: 1500 V AC/minute
- Insulation Resistance: > 500 M Ω

Mechanical Features

- Terminal retention force in housing: > 3 Kgf
- Wire insertion force: < 3 Kgf
- Wire retention force: > 5 kgf



Part Number	Dim. A	Colour	Wire Range	Insulation Diameter
3235 - 2181	1.70 mm.	Red	AWG 18	2.00 mm.
3235 - 2161	2.00 mm.	Green	AWG 16	2.25 mm.
			AWG 14	2.55 mm.