

# CRIMP TERMINAL



## 1993 SERIES. 2.00 mm. (0.039") Pitch housing.

### General Features

- Accommodates wire range AWG 22 through 28 (Options: #22~26 AWG and #24~28 AWG)
- Use in housing 2.00 mm pitch 1990 series
- Box contact with tin plated locking lance
- Maximum insulation diameter 1.50 mm (0.059")

### Materials

- Contact: Phosphor bronze
- Operating temperature -25°C to +85°C

### Dimensional Information

### Electrical Features

- Current rating: < 3 A
- Contact resistance: < 20 mΩ

### Mechanical features

- Durability: 25 cycles
- Wire pull-out force:
 

4.00 Kgf 22 AWG	3.00 Kgf 24 AWG
2.00 Kgf 26 AWG	1.00 Kgf 28 AWG

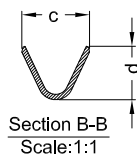
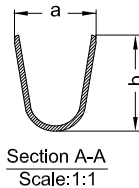
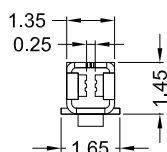
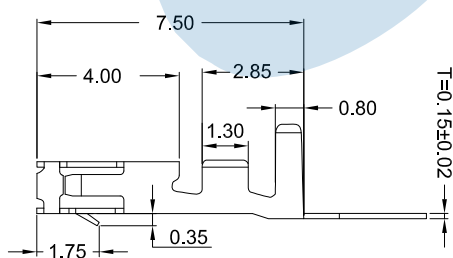
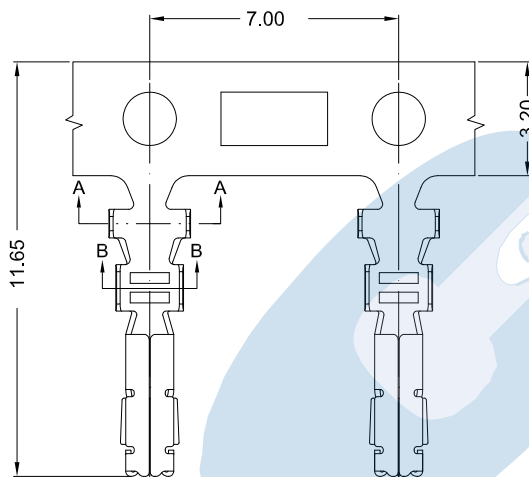

Part Number	Wire range	Dim. a	Dim. b	Dim. c	Dim. d
1993-2000	#24~28	2.20	2.40	1.65	1.30
1993-2010	#22~26	2.30	2.70	1.90	1.50

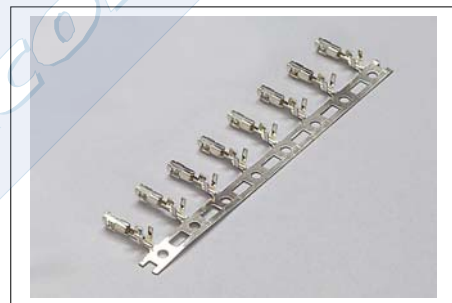

**1993 - 2- XX- E**

1                      2                      3

#### 1. Terminal Serie

#### 2. (XX) AWG Options

- XX = 00. #24~28 AWG
- XX = 10. #22~26 AWG

#### 2. (E) Packing Options

- E = 0. Chain
- E = 1. Loose Piece

