

CRIMP TERMINAL



1801 SERIES. 1.80 mm. (0.071") Pitch housing.

General Features

- Accommodates wire range AWG 22 through 30
- Use in housing 1.80 mm pitch 1800 series
- Tin plated dual beam contact with locking lance
- Max. insulation diameter 1.30 mm (0.075") for 22-26 AWG and 0.95 mm. (0.037") for 28-30 AWG

Materials

- Contact: Phosphor bronze
- Operating temperature -25°C to +85°C

Electrical Features

- Current rating: < 4 A
- Contact resistance: < 30 mΩ

Mechanical Features

- Durability: 25 cycles
- Terminal insertion force to housing : < 0,60 Kgf
- Wire pull-out force: 5.0 Kgf 22 AWG
3.0 Kgf 24 AWG
2.0 Kgf 26 AWG
1.30 Kgf 28 AWG
0.80 Kgf 30 AWG

Dimensions

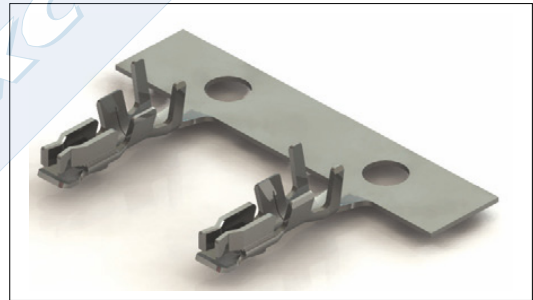
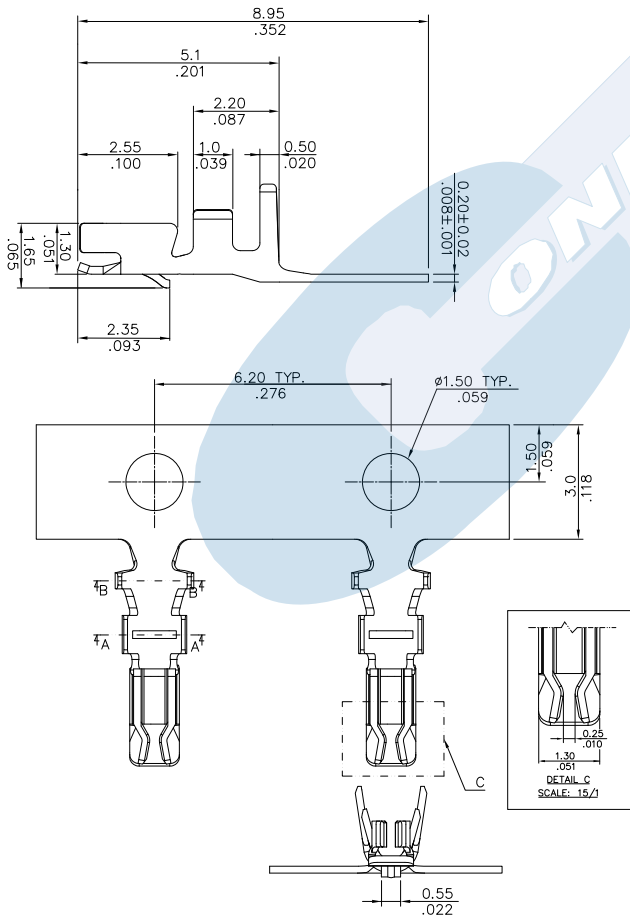

1801 - 2- SS- E

1 2 3

1. Terminal Serie

2. (SS) AWG Options

- SS = 00. 28-30 AWG
- SS = 01. 22-26 AWG

3. (E) Packing Options

- E = 0. Chain
- E = 1. Loose piece

