

# S/ ROW DUAL BODY VERTICAL PIN HEADER



## 1351 SERIES. 1.27 mm (0.050") pitch.

### General Features

- Available in 2 through 33 circuits
- Mates with sockets 1.27mm.pitch 1376,1377 & 1378 series
- 0,40 mm. square pin with different plating
- Available with different pin length
- Contact sales office

### Materials

- Insulator: High temperature thermoplastic UL 94 V-0
- Contact: Brass
- Operating temperature: -40°C to +105°C
- RoHS compliant

### Dimension Information

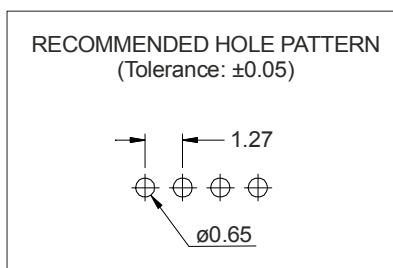
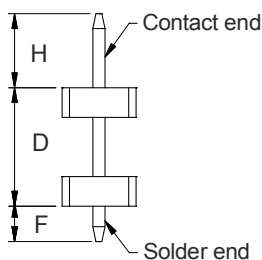
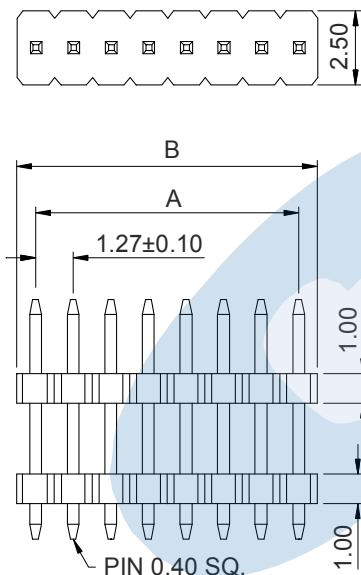

### Electrical Features

- Voltage rating: < 100V
- Current rating: < 1 A
- Contact resistance: < 20 mΩ
- Dielectric withstanding Voltage: 300 V AC/minute
- Insulation resistance: >1000 MΩ
- Capacitance: < 2 pF at 1 KHz

### Mechanical Features

- Pin retention force to insulator: > 0,15 Kgf
- Durability: 50 cycles

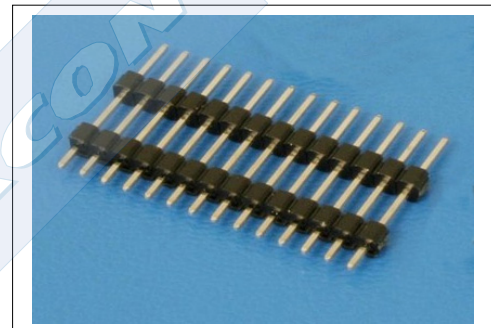

### Ordering Information:

**1351 - T- XX- C**  
 1 2 3 4

#### 1. Connector Series

#### 2. (T) Contact Plating

- T = 2. Tin plated
- T = 3. Gold flash over 50µ" nickel  
Recommended Finish
- T = 5. 15µ" gold over 50µ" nickel
- T = 6. 30µ" gold over 50µ" nickel

#### 3. (XX) Circuit Size

- Available in 2 through 33 circuits

#### 4. (C) Pin dimensions

- C = 1. H: 2.50mm. D: 4.00 mm. F: 1.20 mm.

Other options consult the Sales Office

#### Dimensions: (In mm.)

A = 1.27 x (XX\*-1)

B = 1.27 x (XX)

\* XX (N° of circuits)