

SINGLE ROW CRIMP EDGE CONNE. HOUSING



1046 SERIES. 1.00 mm. (0.039") Pitch.

General Features

- Available in 30 circuits
- Mates with LDVS receptacle
- Compact, low profile design
- Use crimp terminal 1047 series
- With latch to fix to receptacle

Materials

- Insulator: Polyester UL 94 V-0, colour Nature
- Terminal: Tin plated brass
- Operating temperature: -25°C to +85°C
- RoHS compliant

Dimension Information

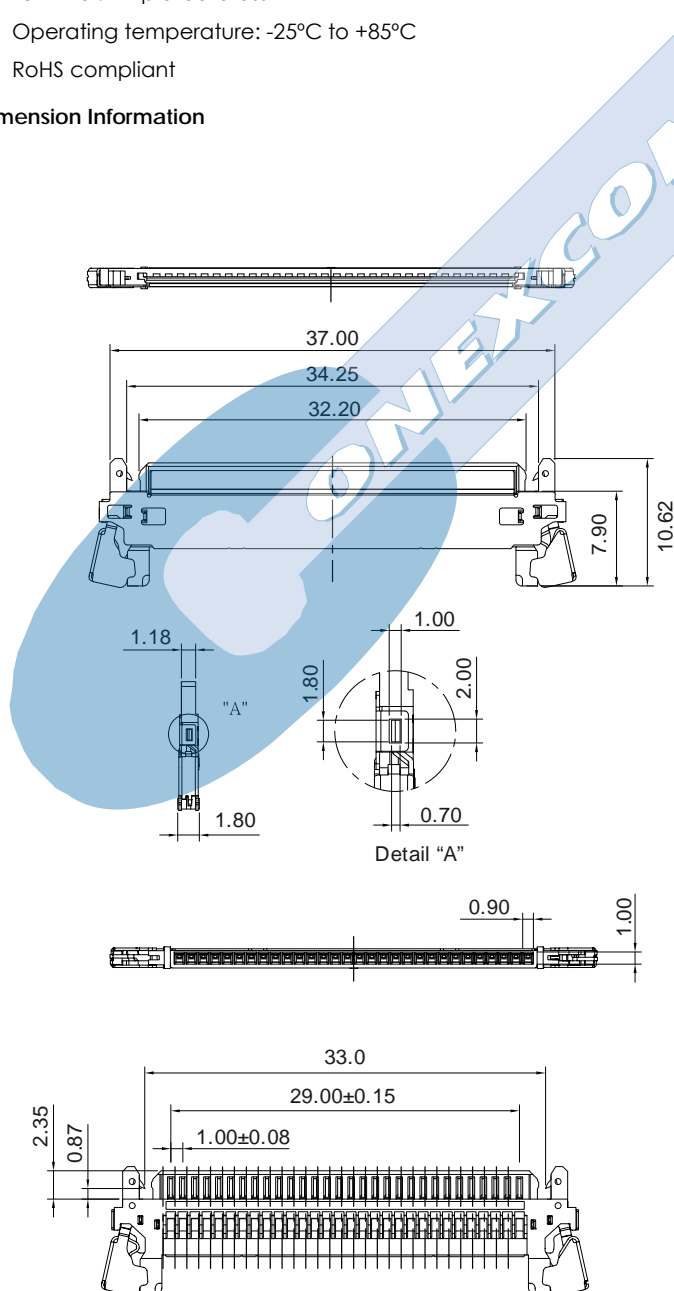

Electrical Features

- Voltage rating: < 200 V
- Current rating: < 1 A
- Contact resistance: < 40 mΩ
- Dielectric withstanding voltage: 500 V AC/minute
- Insulation resistance: >100 MΩ

Mechanical Features

- Durability: 25 cycles

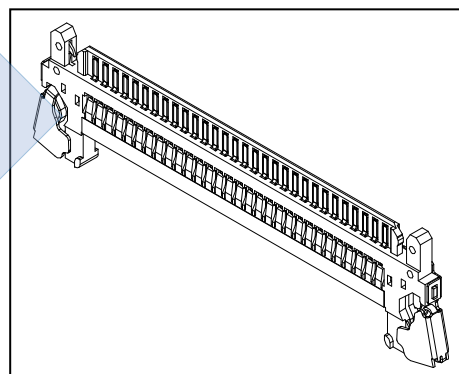

1046 - 2- 30- 1
1 2 3

1. Connector Serie

2. (T) Contacts Plating

- T = 2. Tin plated
RECOMMENDED FINISH

3. (XX) Number of circuits

- Available in 30 circuits