

SINGLE ROW RIGHT ANGLE HEADER



SERIE 2567. (0.100"). For PCB solder.

Features

- Available in 2 through 40 circuits
- Mates with 2.54 mm (.100") single row sockets
- Glass filled polyester UL 94V-0 black color
- 0.64 mm (.025") square pin
- Pin length and plating options are available
- Without polarization. Easy breakway to desired circuits
- Other options consult with Commercial Department

Figuras y dimensiones

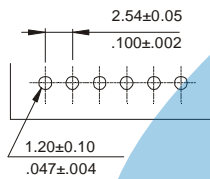
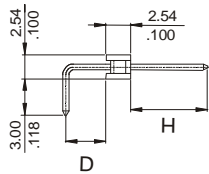
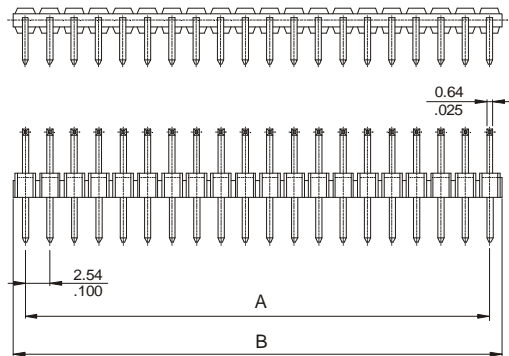

RECOMMENDED HOLE PATTERN

C = Pin Length

- | | |
|------------------------------|--------------|
| ● C = 0. Dim. H = 2.80 mm. | D = 1.50 mm. |
| ● C = 2. Dim. H = 6.85 mm. | D = 1.50 mm. |
| ● C = 3. Dim. H = 7.26 mm. | D = 1.50 mm. |
| ● C = 4. Dim. H = 8.00 mm. | D = 1.50 mm. |
| ● C = 5. Dim. H = 3.30 mm. | D = 3.30 mm. |
| ● C = 6. Dim. H = 6.26 mm. | D = 1.50 mm. |
| ● C = 7. Dim. H = 8.86 mm. | D = 1.50 mm. |
| ● C = 8. Dim. H = 5.86 mm. | D = 1.50 mm. |
| ● C = 9. Dim. H = 6.00 mm. | D = 1.50 mm. |
| ● C = 10. Dim. H = 15.00 mm. | D = 1.50 mm. |
| ● C = 15. Dim. H = 9.00 mm. | D = 3.00 mm. |
| ● C = 16. Dim. H = 25.00 mm. | D = 3.00 mm. |
| ● C = 17. Dim. H = 6.00 mm. | D = 2.00 mm. |
| ● C = 18. Dim. H = 8.00 mm. | D = 3.20 mm. |
| ● C = 19. Dim. H = 3.40 mm. | D = 1.50 mm. |
| ● C = 20. Dim. H = 10.65 mm. | D = 1.50 mm. |

Part number and dimensions

Circuits Size	Part Number	Dimensions	
		A	B
02	2567-T02C	2,54(0,100)	5,08(0,100)
03	2567-T03C	5,08(0,200)	7,62(0,150)
04	2567-T04C	7,62(0,300)	10,16(0,200)
05	2567-T05C	10,16(0,400)	12,70(0,250)
06	2567-T06C	12,70(0,500)	15,24(0,300)
07	2567-T07C	15,24(0,600)	17,78(0,350)
08	2567-T08C	17,78(0,700)	20,32(0,400)
09	2567-T09C	20,32(0,800)	22,86(0,450)
10	2567-T10C	22,86(0,900)	25,40(0,500)
11	2567-T11C	25,40(1,000)	27,94(0,550)
12	2567-T12C	27,94(1,100)	30,48(0,600)
13	2567-T13C	30,48(1,200)	33,02(0,650)
14	2567-T14C	33,02(1,300)	35,56(0,700)
15	2567-T15C	35,56(1,400)	38,10(0,750)
16	2567-T16C	38,10(1,500)	40,64(0,800)
17	2567-T17C	40,64(1,600)	43,18(0,850)
18	2567-T18C	43,18(1,700)	45,72(0,900)
19	2567-T19C	45,72(1,800)	48,26(0,950)
20	2567-T20C	48,26(1,900)	50,80(1,000)
21	2567-T21C	50,80(2,000)	53,34(1,050)
22	2567-T22C	53,34(2,100)	55,88(1,100)
23	2567-T23C	55,88(2,200)	58,42(1,150)
24	2567-T24C	58,42(2,300)	60,96(1,200)
25	2567-T25C	60,96(2,400)	63,50(1,250)
26	2567-T26C	63,50(2,500)	66,04(1,300)
27	2567-T27C	66,04(2,600)	68,58(1,350)
28	2567-T28C	68,58(2,700)	71,12(1,400)
29	2567-T29C	71,12(2,800)	73,66(1,450)
30	2567-T30C	73,66(2,900)	76,20(1,500)
31	2567-T31C	76,20(3,000)	78,74(1,550)
32	2567-T32C	78,74(3,100)	81,28(1,600)
33	2567-T33C	81,28(3,200)	83,82(1,650)
34	2567-T34C	83,82(3,300)	86,36(1,700)
35	2567-T35C	86,36(3,400)	88,90(1,750)
36	2567-T36C	88,90(3,500)	91,44(1,800)
37	2567-T37C	91,44(3,600)	93,98(1,850)
38	2567-T38C	93,98(3,700)	96,52(1,900)
39	2567-T39C	96,52(3,800)	99,06(1,950)
40	2567-T40C	99,06(3,900)	101,60(2,000)

T = Plating options

- T = 2. Tin plated.
- T = 3. Gold flash over 30-50μ nickel overall
RECOMENDED VERSION
- T = 5. 15μ gold over 30-50μ nickel overall
- T = 6. 30μ gold over 30-50μ nickel overall

