

DUAL ROW RIGHT ANGLE HEADER



2559 SERIES. 2.54mm(0.100").Dual Row Breakaway Right Angle Header

Features

- Available in 4 through 80 circuits
- Mates with 2.54mm(0.100") dual row socket
- Material Glass filled Polyester UL 94V-0, Colour Black
- 0.64mm(0.025") square pin in copper alloy
- Different pin length and plating options are available
- Easy breakaway to desired circuit size
- Without polarisation
- For other options consult the Sales Office

Dimensional Information

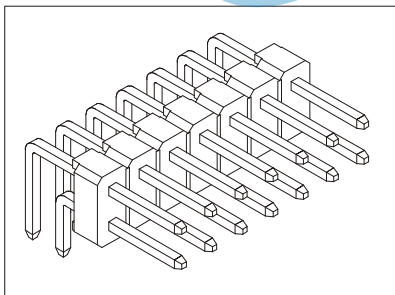
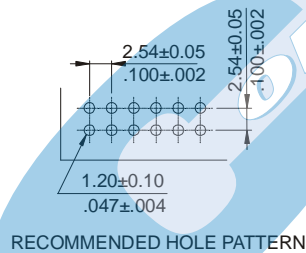
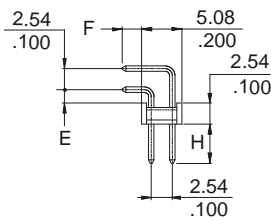
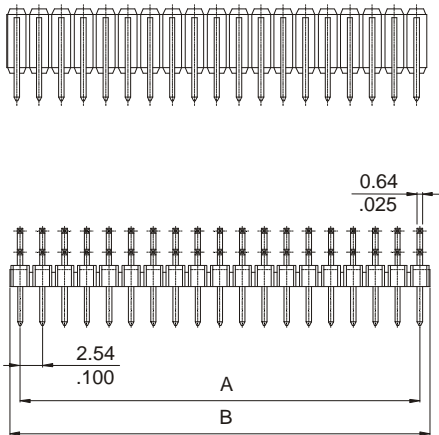

C = Pin Length

- C = 1. H= 5.86 E= 1.50 F=3.00
- C = 2. H= 6.85 E= 1.50 F=3.00
- C = 3. H= 8.30 E= 1.50 F=3.00
- C = 5. H= 9.00 E= 1.50 F=3.00
- C = 6. H= 3.00 E= 1.50 F=3.00
- C = 7. H= 6.90 E= 3.00 F=1.50
- C = 9. H= 7.26 E= 1.50 F=3.00

Ordering and Dimensional Information

Circuit Size	Part Number	Dimension	
		A	B
04	2559-T04C	2,54(0,100)	5,08(0,200)
06	2559-T06C	5,08(0,200)	7,62(0,300)
08	2559-T08C	7,62(0,300)	10,16(0,400)
10	2559-T10C	10,16(0,400)	12,70(0,500)
12	2559-T12C	12,70(0,500)	15,24(0,600)
14	2559-T14C	15,24(0,600)	17,78(0,700)
16	2559-T16C	17,78(0,700)	20,32(0,800)
18	2559-T18C	20,32(0,800)	22,86(0,900)
20	2559-T20C	22,86(0,900)	25,40(1,000)
22	2559-T22C	25,40(1,000)	27,94(1,100)
24	2559-T24C	27,94(1,100)	30,48(1,200)
26	2559-T26C	30,48(1,200)	33,02(1,300)
28	2559-T28C	33,02(1,300)	35,56(1,400)
30	2559-T30C	35,56(1,400)	38,10(1,500)
32	2559-T32C	38,10(1,500)	40,64(1,600)
34	2559-T34C	40,64(1,600)	43,18(1,700)
36	2559-T36C	43,18(1,700)	45,72(1,800)
38	2559-T38C	45,72(1,800)	48,26(1,900)
40	2559-T40C	48,26(1,900)	50,80(2,000)
42	2559-T42C	50,80(2,000)	53,34(2,100)
44	2559-T44C	53,34(2,100)	55,88(2,200)
46	2559-T46C	55,88(2,200)	58,42(2,300)
48	2559-T48C	58,42(2,300)	60,96(2,400)
50	2559-T50C	60,96(2,400)	63,50(2,500)
52	2559-T52C	63,50(2,500)	66,04(2,600)
54	2559-T54C	66,04(2,600)	68,58(2,700)
56	2559-T56C	68,58(2,700)	71,12(2,800)
58	2559-T58C	71,12(2,800)	73,66(2,900)
60	2559-T60C	73,66(2,900)	76,20(3,000)
62	2559-T62C	76,20(3,000)	78,74(3,100)
64	2559-T64C	78,74(3,100)	81,28(3,200)
66	2559-T66C	81,28(3,200)	83,82(3,300)
68	2559-T68C	83,82(3,300)	86,36(3,400)
70	2559-T70C	86,36(3,400)	88,90(3,500)
72	2559-T72C	88,90(3,500)	91,44(3,600)
74	2559-T74C	91,44(3,600)	93,98(3,700)
76	2559-T76C	93,98(3,700)	96,52(3,800)
78	2559-T78C	96,52(3,800)	99,06(3,900)
80	2559-T80C	99,06(3,900)	101,60(4,000)

T = Contact Plating

- T = 2. Tin plated
- T = 3. Gold flash over 50µ" nickel.
Recommended Finish
- T = 5. 15µ" gold over 50µ" nickel
- T = 6. 30µ" gold over 50µ" nickel
- T = 13. Selective gold flash over 50µ" nickel
- T = 15. 15µ" selective gold over 50µ" nickel
- T = 16. 30µ" selective gold over 50µ" nickel