

CRIMP TERMINAL



2538 SERIES. 2.50mm Crimp Terminal

Features

- Used in 2535 series socket
- Accommodates wire ranges AWG 22-28
- Material : Phosphor bronze
- Mates with 0.70mm(0.028") round pin
- Plating: Tin plated
- Insulation Diameter: 1.50mm(0.059") Max.

Dimensional Information

Ordering and Dimensional Information

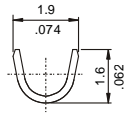
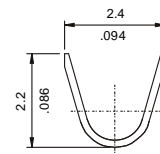
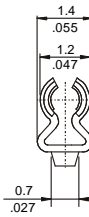
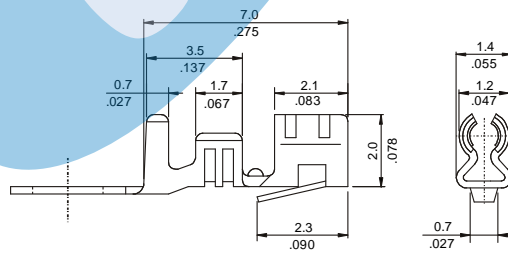
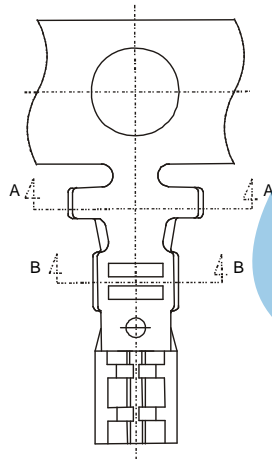

Reel Quantity	Part Number	Material	Wire Ranges	Insulation Diameter
10,000 Pcs (Reel)	2538 - 2002	Phosphor Bronze	AWG 22 - 28	1.50(0.059") Max.
Loose Piece	2538 - 2001	Phosphor Bronze	AWG 22 - 28	1.50(0.059") Max.